

REVISIONS		
REV. NO.	DESCRIPTION	DATE

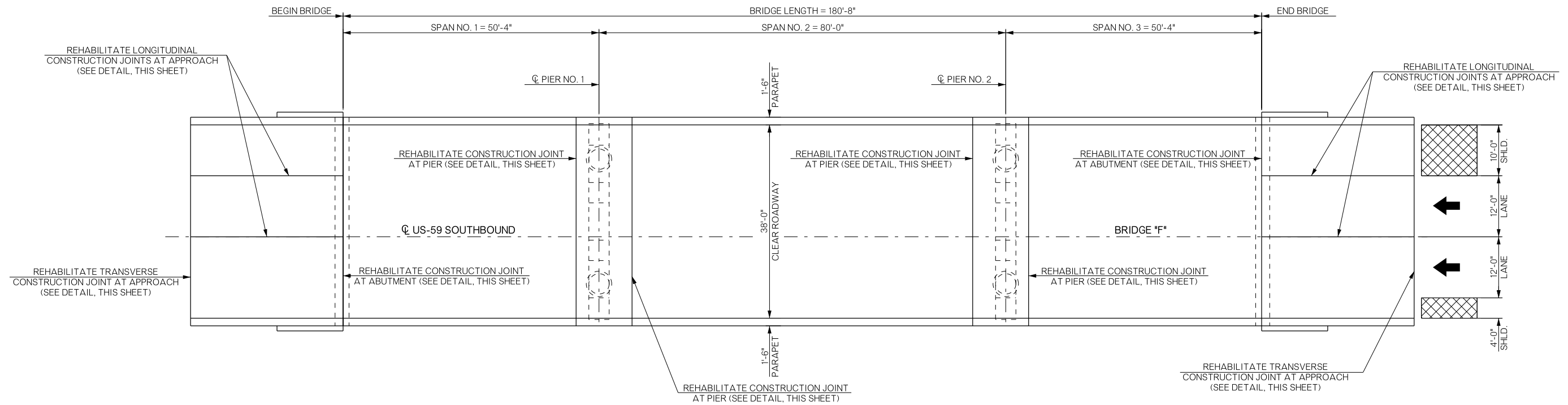

PLAN

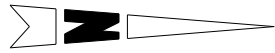
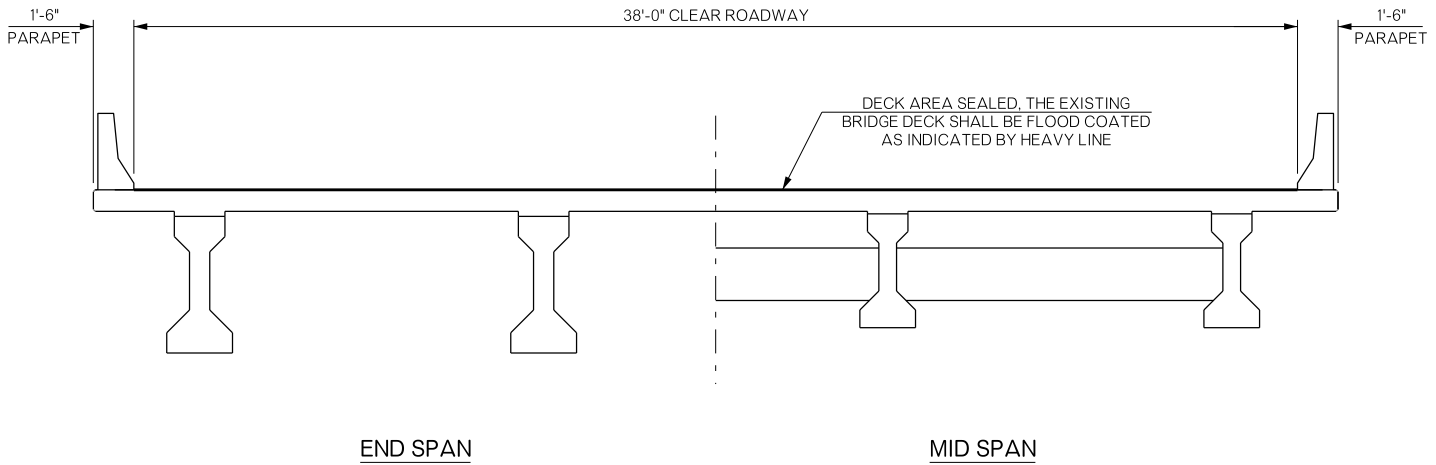

TYPICAL SECTION

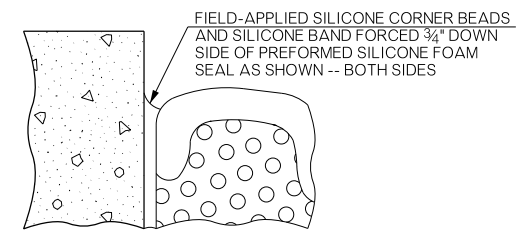

DETAIL 'A'

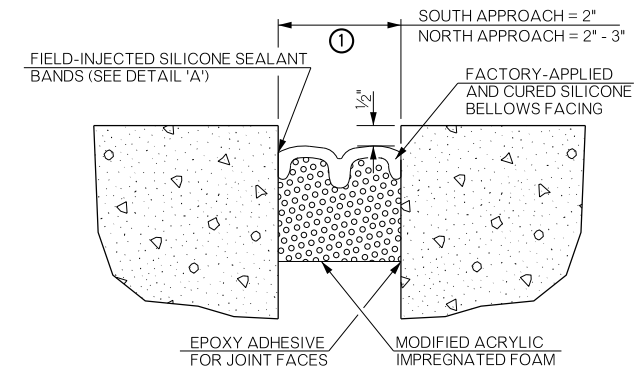

REHABILITATED TRANSVERSE CONSTRUCTION JOINT AT APPROACHES

① SOUTH END APPROACH TO BE FOAM SEALED WITH A WIDTH AS SHOWN. NORTH END APPROACH TO BE FOAM SEALED HAS A VARIABLE OPENING WIDTH AS SHOWN. (THESE VARIANCES SHOULD BE RESPECTED AND TAKEN INTO ACCOUNT IN THE FIELD. PREFORMED FOAM MAY NEED TO BE "STEPPE" (I.E. SECTIONED FROM DIFFERENT DEFAULT OFFERED WIDTHS.)

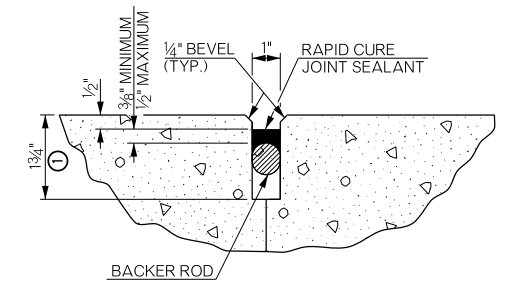

REHABILITATED CONSTRUCTION JOINT AT ABUTMENTS, PIERS, AND LONGITUDINAL CONSTRUCTION JOINT AT APPROACHES

① SAW TO THE DEPTH SHOWN TO PROVIDE CLEAN STRAIGHT SURFACES. REFER TO LECS-4-1 STANDARD DETAIL SHEET FOR ADDITIONAL INFORMATION.

BRIDGE "F" US-59 SOUTHBOUND OVER COAL CREEK	LE FLORE COUNTY	Design	N/A	N/A
GENERAL PLAN AND TYPICAL SECTION (BRIDGE "F")		Detail	MSW	5/17
		Check	RAH	6/17
STATE OF OKLAHOMA		Squad	HENSLLEY	
DEPARTMENT OF TRANSPORTATION		Engr.	DEFRANCO	
JOB/PIECE NO. 33217(04)	SHEET NO. B009			